



XAN

**EXTERNAL
RETAINING
RINGS**

**Applicable Shaft
0.312" to 1.875"**

Standard Material
Carbon Spring Steel



**THIS STYLE ONLY
ON XAN 31 THRU XAN 43**

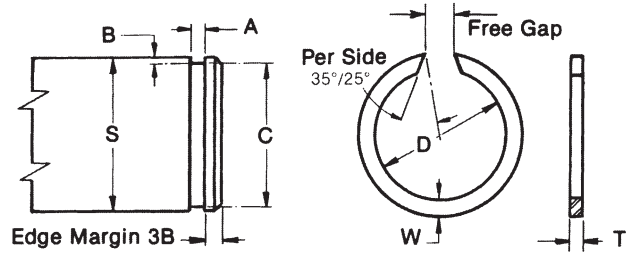

Material Steel SAE 1060 to 1075 Hardness R/C42-53

PART NUMBER	SHAFT			RING				GROOVE			FREE GAP		RING THRUST CAPACITY LBS.	
	DIAMETER S			FREE DIAMETER		WIRE SECTION		DIA.		WIDTH A	NOM. DEPTH B	MIN.		MAX.
	Frac. inch	Dec. inch	mm	D inches	Tol. inches	W ±.005	T ±.002	C	Tol.					
XAN31	5/16	.312	7.92	.281				.290			.011			180
XAN34	11/32	.344	8.74	.312	+0.00			.322						190
XAN35	-	.354	8.99	.320	-.015			.330						210
XAN37	3/8	.375	9.53	.341		.040	.025	.351		.028	.012	.031	.156	230
XAN39	-	.393	9.98	.359		±.003		.369		+0.003 -0.000				260
XAN40	13/32	.406	10.31	.372	+0.00			.382						280
XAN43	7/16	.438	11.13	.402	-.020			.412						300
XAN46	15/32	.469	11.91	.433				.443			.013			320
XAN50	1/2	.500	12.70	.464				.474	±.002					460
XAN55	-	.551	14.00	.514		.048		.524						480
XAN56	9/16	.562	14.27	.524		±.003	.035	.534		.039				490
XAN59	19/32	.594	15.09	.555				.566		+0.003 -0.000	.014			510
XAN62	5/8	.625	15.88	.586	+0.00			.597				.062	.218	520
XAN66	-	.669	17.00	.630	-.025			.640			.015			570
XAN68	11/16	.688	17.48	.644		.062		.656			.016			700
XAN75	3/4	.750	19.05	.703		±.003		.716			.017			820
XAN78	25/32	.781	19.84	.733				.745			.018			950
XAN81	13/16	.812	20.62	.764				.776		.046				1010
XAN87	7/8	.875	22.23	.820		.078	.042	.835		+0.003 -0.000	.020			1100
XAN93	15/16	.938	23.83	.881		±.003		.896			.021	.093	.250	1130
XAN98	63/64	.984	25.00	.925				.940			.022			1170
XAN100	1	1.000	25.40	.941				.956	±.003					1200
XAN102	-	1.023	25.98	.962				.977			.023			1300
XAN106	11/16	1.062	26.97	1.000	+0.00	.093		1.016						1600
XAN112	1 1/8	1.125	28.58	1.060	-.031	±.003		1.075		.056	.025			1880
XAN118	13/16	1.188	30.18	1.121				1.136		+0.004 -0.000	.026	.156	.312	1990
XAN125	1 1/4	1.250	31.75	1.179				1.194			.028			2090
XAN131	15/16	1.312	33.32	1.232			.050	1.250			.031			2100
XAN137	13/8	1.375	34.93	1.291		.109		1.309			.033			2300
XAN143	17/16	1.438	36.53	1.351		±.003		1.370			.034			2460
XAN150	1 1/2	1.500	38.10	1.408				1.430			.035			2500
XAN156	19/16	1.562	39.67	1.467				1.490	±.004		.036			3060
XAN162	15/8	1.625	41.28	1.527		.125		1.551			.037			3190
XAN168	1 11/16	1.687	42.85	1.581	+0.00	±.005		1.611		.068	.038			3370
XAN175	13/4	1.750	44.45	1.640	-.046		.062	1.670		+0.004 -0.000	.040	.156	.375	3510
XAN177	-	1.771	44.98	1.657		.141		1.687			.042			3550
XAN181	1 13/16	1.812	46.02	1.698		±.005		1.728			.042			3640
XAN187	1 7/8	1.875	47.63	1.759		.156 ±.005		1.789			.043			3760

**Applicable Shaft
1.969" to 10.00"**

Standard Material
Carbon Spring Steel



XAN

**EXTERNAL
RETAINING
RINGS**

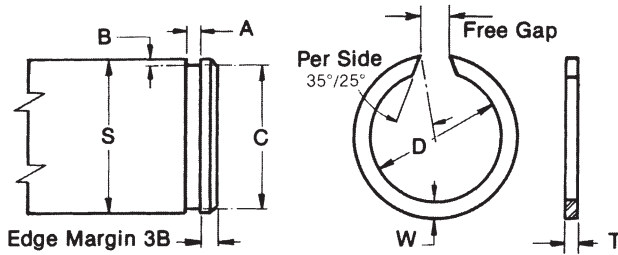

Material Steel SAE 1060 to 1075 Hardness R/C42-53

**THIS STYLE ONLY
ON XAN 31 THRU XAN 43**

PART NUMBER	SHAFT			RING				GROOVE			FREE GAP		RING THRUST CAPACITY LBS.	
	DIAMETER S			FREE DIAMETER		WIRE SECTION		DIA.		WIDTH A	NOM. DEPTH B	MIN.		MAX.
	Frac. inch	Dec. inch	mm	D inches	Tol. inches	W ±.005	T ±.002	C	Tol.					
XAN196	1 ³¹ / ₃₂	1.969	48.99	1.849			.062	1.879		.068	.045			3940
XAN200	2	2.000	50.80	1.880				1.910		.068	.045			4010
XAN206	2 ¹ / ₁₆	2.062	52.37	1.936		.156		1.966		.068	.048			5350
XAN212	2 ¹ / ₈	2.125	53.98	1.997		±.005		2.027		.068	.049			5470
XAN215	2 ⁵ / ₃₂	2.156	54.76	2.026				2.056		.068	.050			5680
XAN225	2 ¹ / ₄	2.250	57.15	2.116	+ .000			2.146		.068	.052			5790
XAN231	2 ⁵ / ₁₆	2.312	58.72	2.174	.046			2.204		.086	.054	.156	.375	6300
XAN237	2 ³ / ₈	2.375	60.33	2.235			.078	2.265		.068	.055			6400
XAN243	2 ⁷ / ₁₆	2.437	61.90	2.295				2.325		.068	.056			6500
XAN250	2 ¹ / ₂	2.500	63.50	2.356				2.386		.068	.057			6600
XAN255	-	2.559	65.00	2.413		.187		2.443		.068	.058			6700
XAN262	2 ⁵ / ₈	2.625	66.68	2.475		±.005		2.505		.068	.060			6800
XAN268	2 ¹¹ / ₁₆	2.687	68.25	2.535				2.565		.068	.061			6900
XAN275	2 ³ / ₄	2.750	69.85	2.594				2.624		.068	.063			8460
XAN287	2 ⁷ / ₈	2.875	73.03	2.713				2.743		.068	.066			8840
XAN293	2 ¹⁵ / ₁₆	2.937	74.60	2.771				2.801		.068	.068			9030
XAN300	3	3.000	76.20	2.830				2.860		.103	.070			9230
XAN306	3 ¹ / ₁₆	3.062	77.77	2.890	+ .000	.218	.093	2.920		.068	.071	.187	.437	9420
XAN312	3 ¹ / ₈	3.125	79.38	2.951	-.062	±.005		2.981		.068	.072			9630
XAN315	3 ⁵ / ₃₂	3.156	80.16	2.980				3.010	±.006	.068	.073			9800
XAN325	3 ¹ / ₄	3.250	82.55	3.070				3.100		.068	.075			10000
XAN334	3 ¹¹ / ₃₂	3.344	84.94	3.160				3.190		.068	.077			10290
XAN343	3 ⁷ / ₁₆	3.437	87.30	3.251				3.281		.068	.078			10570
XAN350	3 ¹ / ₂	3.500	88.90	3.305		.250		3.340		.068	.080			11970
XAN354	-	3.543	90.00	3.346		±.005		3.381		.068	.081			12120
XAN362	3 ⁵ / ₈	3.625	92.08	3.423	+ .000			3.458		.068	.083			12300
XAN368	3 ¹¹ / ₁₆	3.687	93.65	3.482	-.078			3.517		.068	.085	.250	.562	12600
XAN375	3 ³ / ₄	3.750	95.25	3.541				3.576		.068	.087			12800
XAN387	3 ⁷ / ₈	3.875	98.43	3.657				3.697		.120	.089			13200
XAN393	3 ¹⁵ / ₁₆	3.938	100.02	3.713		.281	.109	3.758		.068	.090			13470
XAN400	4	4.000	101.60	3.771		±.005		3.816		.068	.092			13650
XAN425	4 ¹ / ₄	4.250	107.95	4.016				4.066		.068	.092			15000
XAN437	4 ³ / ₈	4.375	111.13	4.141	+ .000			4.191		.068	.092			15500
XAN450	4 ¹ / ₂	4.500	114.30	4.255	-.093	.312		4.310		.068	.095	.250	.656	16200
XAN475	4 ³ / ₄	4.750	120.65	4.495		±.005		4.550		.068	.100			16480
XAN500	5	5.000	127.00	4.730				4.790		.068	.105			17110
XAN525	5 ¹ / ₄	5.250	133.35	4.970				5.030		.068	.110			20590
XAN550	5 ¹ / ₂	5.500	139.70	5.206	+ .000	.375		5.266		.139	.117			21790
XAN575	5 ³ / ₄	5.750	146.05	5.446	-.125	±.005	.125	5.506		.068	.122	.250	.750	23010
XAN590	-	5.900	149.86	5.600				5.656		.068	.122			23625
XAN600	6	6.000	152.40	5.687				5.746		.068	.127			24000
XAN625	6 ¹ / ₄	6.250	158.75	5.916				5.986		.068	.132			30310
XAN650	6 ¹ / ₂	6.500	165.10	6.151	+ .000	.437	.156	6.226		.174	.137	.250	.750	33760
XAN675	6 ³ / ₄	6.750	171.45	6.386	-.125	±.005		6.466		.068	.142			36840
XAN700	7	7.000	177.80	6.621				6.706		.068	.147			39920
XAN725	7 ¹ / ₄	7.250	184.15	6.840				6.930		.068	.160			43100
XAN750	7 ¹ / ₂	7.500	190.50	7.090				7.180	±.008	.068	.160			44500
XAN800	8	8.000	203.20	7.560				7.660		.209	.160			45500
XAN850	8 ¹ / ₂	8.500	215.90	8.050	+ .000	.500	.187	8.160		.068	.170	.250	.875	46700
XAN900	9	9.000	228.60	8.545	-.156	±.005		8.660		.068	.170			49900
XAN925	9 ¹ / ₄	9.250	234.95	8.800				8.910		.068	.170			51000
XAN950	9 ¹ / ₂	9.500	241.30	9.040				9.160		.068	.170			52590
XAN1000	10	10.000	254.00	9.535				9.660		.068	.170			55600

