

**Applicable Shaft
0.500" to 8.000"**

Standard Material
Carbon Spring Steel



R-XD

**EXTERNAL
RETAINING
RINGS
(LIGHT DUTY)**



THIS STYLE ONLY
ON XD50 and XD62.

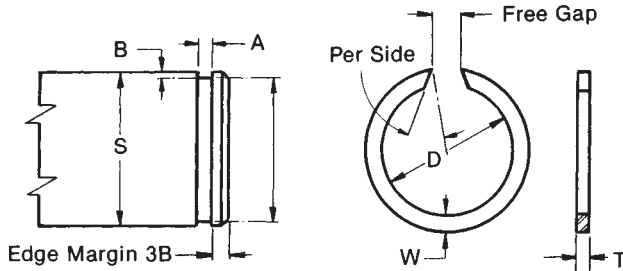

Material Steel SAE 1060 to 1075 Hardness R/C42-53

PART NUMBER	SHAFT			RING				GROOVE			FREE GAP		RING THRUST CAPACITY LBS.	
	DIAMETER S			FREE DIAMETER		WIRE SECTION		DIA.		WIDTH	NOM. DEPTH	MIN.		MAX.
	Frac. inch	Dec. inch	mm	D inches	Tol. inches	W ±.005	T ±.002	C ±.006	Tol.	A	B			
R-XD50	1/2	.500	12.70	.465	+0.000	.048±.003	.035	.474		.039	.013			460
R-XD62	5/8	.625	15.88	.587	-.025	.062±.003	.035	.597	±.002	.039	.014	.062	.218	520
R-XD75	3/4	.750	19.05	.704		.078±.003	.042	.716		.039	.017			900
R-XD87	7/8	.875	22.23	.823		.093	.042	.833		.039	.021			1100
R-XD100	1	1.000	25.40	.944		±.003	.042	.954	±.003	.039	.023			1200
R-XD112	1 1/8	1.125	25.58	1.065			.042	1.077		.039	.024			1600
R-XD118	1 3/16	1.187	30.15	1.120	+0.000		.042	1.135		.039	.026			1700
R-XD125	1 1/4	1.250	31.75	1.179	-.031	.125	.042	1.194		.039	.028	.125	.281	1800
R-XD131	1 5/16	1.312	33.32	1.232		±.005	.042	1.252		.039	.030			1900
R-XD137	1 3/8	1.375	34.93	1.289			.042	1.309		.039	.033			2010
R-XD143	1 7/16	1.437	36.50	1.349			.042	1.369	±.004	.046	.034			2120
R-XD150	1 1/2	1.500	38.10	1.410			.042	1.430		.046	.035			2260
R-XD162	1 5/8	1.625	41.28	1.520			.042	1.545		.046				2800
R-XD168	1 11/16	1.687	42.85	1.582			.042	1.607		.046				2900
R-XD175	1 3/4	1.750	44.45	1.645			.042	1.670		.046				3000
R-XD193	1 15/16	1.937	49.20	1.832	+0.000	.156	.042	1.857		.046				3100
R-XD200	2	2.000	50.80	1.895	-.062	±.005	.042	1.920		.046	.040	.156	.437	3200
R-XD218	2 3/16	2.187	55.55	2.082			.042	2.107		.046				3400
R-XD225	2 1/4	2.250	57.15	2.145			.042	2.170		.046				3500
R-XD237	2 3/8	2.375	60.33	2.270			.042	2.295		.046				3600
R-XD250	2 1/2	2.500	63.50	2.390			.042	2.420		.046				3650
R-XD275	2 3/4	2.750	69.85	2.596			.062	2.626		.062				5790
R-XD293	2 15/16	2.937	74.60	2.783			.062	2.813		.062				6150
R-XD300	3	3.000	76.20	2.846	+0.000	.187	.062	2.876		.062				6250
R-XD312	3 1/8	3.125	79.38	2.965	-.078	±.005	.062	3.000	±.006	.068	.062	.156	.468	6400
R-XD325	3 1/4	3.250	82.55	3.090			.062	3.125		.068				6500
R-XD337	3 3/8	3.375	85.73	3.215			.062	3.250		.068				6600
R-XD350	3 1/2	3.500	88.90	3.340			.062	3.375		.068				6700
R-XD375	3 3/4	3.750	95.25	3.570			.078	3.610		.068				8800
R-XD400	4	4.000	101.60	3.820			.078	3.860		.068				9000
R-XD425	4 1/4	4.250	107.95	4.070	+0.000	.218	.078	4.110		.086	.070	.187	.562	9200
R-XD450	4 1/2	4.500	114.30	4.320	-.093	±.005	.078	4.360		.086				9400
R-XD475	4 3/4	4.750	120.65	4.560			.078	4.610		.086				9200
R-XD500	5	5.000	127.00	4.800			.078	4.860		.086				9000
R-XD550	5 1/2	5.500	139.70	5.280			.093	5.340		.086				13000
R-XD600	6	6.000	152.40	5.775	+0.000	.250	.093	5.840		.103	.080	.218	.750	9000
R-XD650	6 1/2	6.500	165.10	6.270	-.125	±.005	.093	6.340		.103				7500
R-XD700	7	7.000	177.80	6.765			.093	6.840	±.008	.103				6100
R-XD750	7 1/2	7.500	190.50	7.245	+0.000	.281	.109	7.320		.120	.090	.218	.812	-
R-XD800	8	8.000	203.24	7.740	-.156	±.005	.109	7.820		.120				-

